

This guide is intended to guide you through the basic functions of this navigation system. For details, please refer to Operation Manual.

Basic Hardware buttons



- ① **MODE button**
Press to switch between the map screen and the audio operation screen.
- ② **MULTI-CONTROL**
Rotate to adjust the audio volume.
- ③ **LIST button**
Press to display a list of songs or folders, when an iPod or other audio source is selected.
- ④ **SRC/OFF button**
Press to select the audio source.
- ⑤ **BAND/ESC button**
Press to change the band for the radio.
- ⑥ **Home button**
Press to remove the detachable device from the head unit.
- ⑦ **Drawer**
Press to open the drawer.

Switching the screen

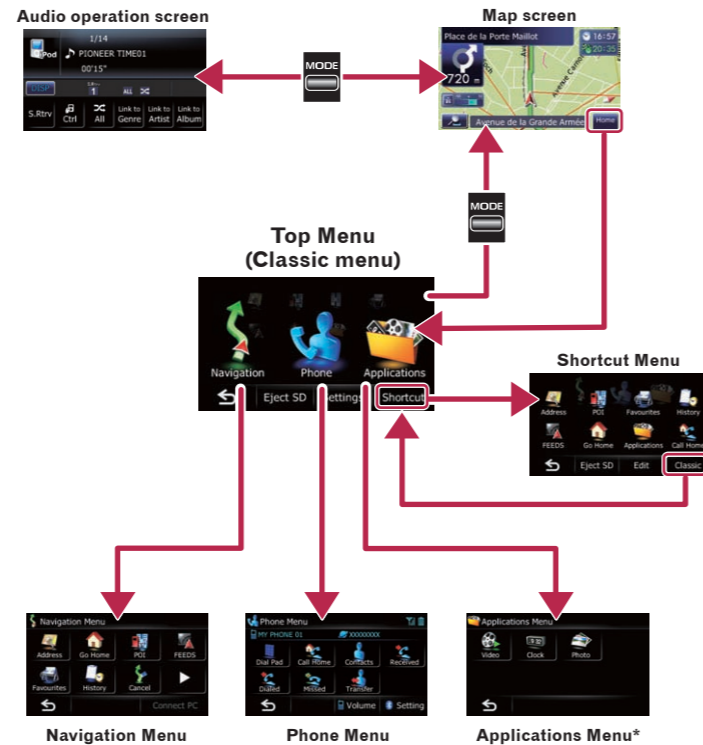

* You can launch applications downloaded to an SD memory card via the utility programme **navgate FEEDS**. For details, please refer to Operation Manual.

Navigation Menu

Touch **Home** on the map screen and touch **Navigation** on the "Top Menu" screen.

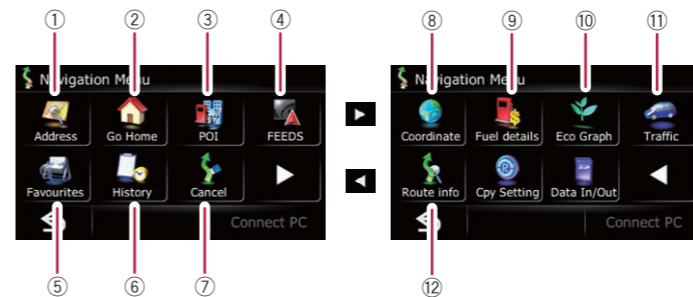

- ① Searches for a location by address
- ② Calculates the route home
- ③ Searches for a place from stores, restaurants, and other businesses in the points of interest database
- ④ Searches for POIs by using the data on external storage devices (SD)
- ⑤ Selects a location from stored locations
- ⑥ Selects a location from previously routed destinations
- ⑦ Cancels your current route
- ⑧ Sets the accurate location from a latitude and longitude
- ⑨ Estimates the fuel cost
- ⑩ Displays a graph for eco-driving
- ⑪ Displays the traffic information
- ⑫ Displays the current route information

Searching for your destination by address

- 1 Display "Navigation Menu" screen and touch **Address**.

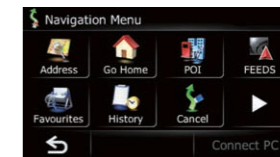

- 2 Input the information that you want to set as the destination.

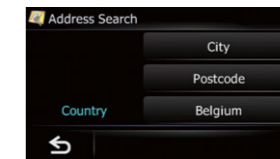

Touch one of the options. After narrowing down your destination, the Location confirmation screen will appear.

- 3 Touch **OK**.

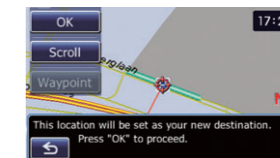

After searching for the destination, the Route confirmation screen appears.

- 4 Touch **OK**.



The navigation system gives you route guidance both visually and by voice.

Basic items on the map



- 1 Name of the street to be used (or next guidance point)
- 2 Current time
- 3 Estimated time of arrival
- 4 Current route
- 5 Current position
- 6 Street name that your vehicle is travelling along
- 7 Zoom in/Zoom out
- 8 Eco-Meter
- 9 Next manoeuvre

Scrolling the map

Drag your finger along the screen to scroll the map.



Setting the volume of the route guidance

- 1 Touch **Settings** on the "Top Menu" screen.
- 2 Touch **Sound**.
- 3 Touch **+** or **-** to change the volume of the route guidance.

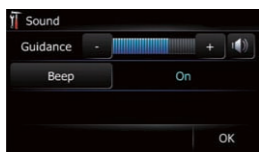

Selecting the audio source

- 1 Press the **MODE** button when the map of the current location is displayed.
- 2 Press the **SRC/OFF** button repeatedly to switch between the following sources.

TUNER (tuner) → **CD** (built-in CD player) → **USB** (USB storage device) → **iPod** (iPod connected using USB input) → **AUX** (auxiliary device)

Note:
The audio source is disabled if the equipment is not connected or inserted.

Using the radio (FM)

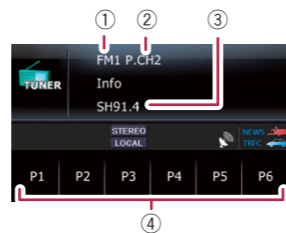

- 1 Shows which band the radio is tuned to
- 2 Shows the selected preset channel
- 3 Shows the programme service name (when available)
- 4 Stores and recalls broadcast frequencies

Playing your Apple iPod

You can control an iPod by connecting the USB interface cable for iPod (supplied) to the navigation system.

- 1 Connect your iPod.

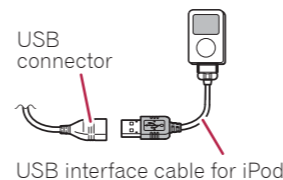

Note:

In this manual, iPod and iPhone will be referred to as iPod.

- 2 Switch the audio source to **iPod**.

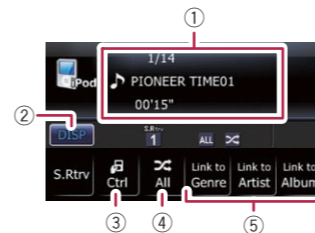

- 1 Shows the song title, the artist name, etc.
- 2 Changes the information of current song/file being played
- 3 Sets iPod control mode. You can switch control of the iPod between the touch screen and the iPod
- 4 Shuffles all songs
- 5 Plays songs related to the currently playing song

- 3 Operate iPod with **MULTI-CONTROL**.

- **Rotating MULTI-CONTROL**
Adjusts the audio source volume.
- **Pressing MULTI-CONTROL right or left**
Skips the song forward or backward.
- **Pressing the centre of MULTI-CONTROL**
Selects the desired item.
- **Pressing and holding MULTI-CONTROL right or left**
Performs fast forward or reverse.

Pairing your phone

- 1 Activate the **Bluetooth** function on your phone.
- 2 Touch the keys in the following order on the "Top Menu" screen; **Phone** → **Settings**.
- 3 Touch **Bluetooth On/Off** to select **On**.



- 4 Touch the keys in the following order; **Connections** → **Add** → **Search devices**. The system tries to find and lists nearby devices.



- 6 Enter the **PIN code** from your phone. (The PIN code is "1111".)
When the pairing is successful, a message will appear.

Transferring the phone book

- 1 Connect the mobile phone.
- 2 Touch **Transfer** on the "Phone Menu".

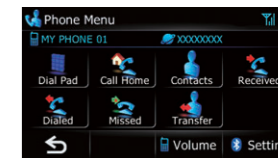

- 3 Touch **OK**.

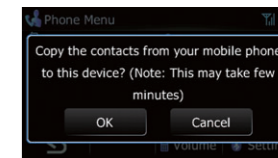

- 4 Check that the following screen is displayed, and operate your mobile phone to transfer the phone book entries.

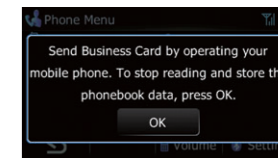

- 5 After transferring, touch **OK**.
When the transfer is successful, "**Completed data loading!**" will appear.